

WLS Series Installation Modular Light Strip

Description

The WLS Series is a linear lighting solution whose modular design offers a multitude of possibilities. Simple and flexible installation, light intensity and CCT selectable, programmable with optional occupancy sensor. Durable and robust, the WLS Series offers Tri-Proof protection (protection against water, dust and corrosion) and is suitable for many applications including factory workspaces, warehouses, corridors, indoor parking, stairs, etc.

Features

- Adjustable luminaire: light intensity (50%-75%-100%) / CCT (3500K-4000K-5000K)
- Ready for optional occupancy sensor
- Programmable luminaire via remote controller
- Simple and flexible installation: standalone / linkable / seamless without interruption

Product parameters

Series	Power(w)	Net weight	Input current	Input voltage frequency
WLS	55W	1.5Kg	Max0.65A	50-60Hz
LED type:SMD		Application environment:-20°C~+40°C		
Beam angle:120°		Storage temperature:-30°C~+65°C		
CRI:>80		Material:Q235+PC		
Suitable for wet location		Corrosion-proof grade:W		

To ensure proper usage of the lamps, please carefully read and keep this instruction manual for future reference.

Dimension(Unit:mm/inch)

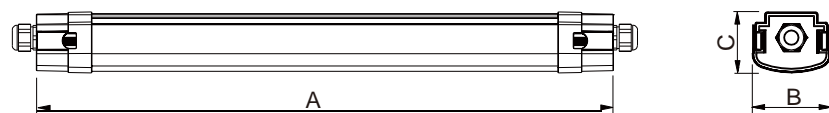

Identification	A	B	C
55W	1200mm/47.25"	78mm/3.07"	60mm/2.37"

Product Installation

Single lamp ceiling installation:

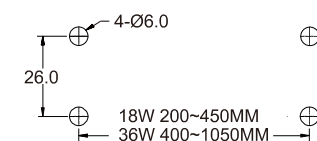

Cutout size for installation

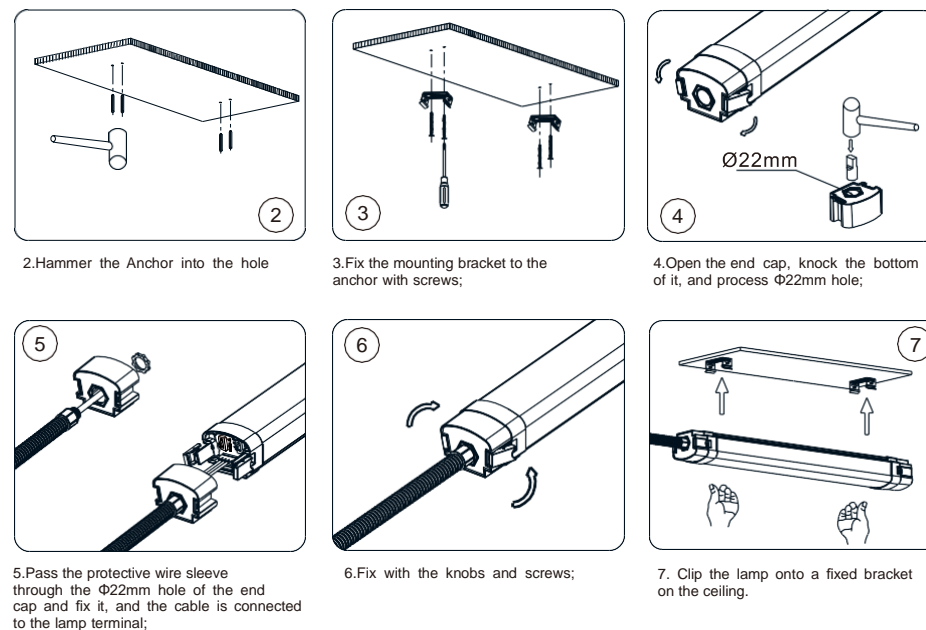

Ceiling installation of multi lamps wire in series:

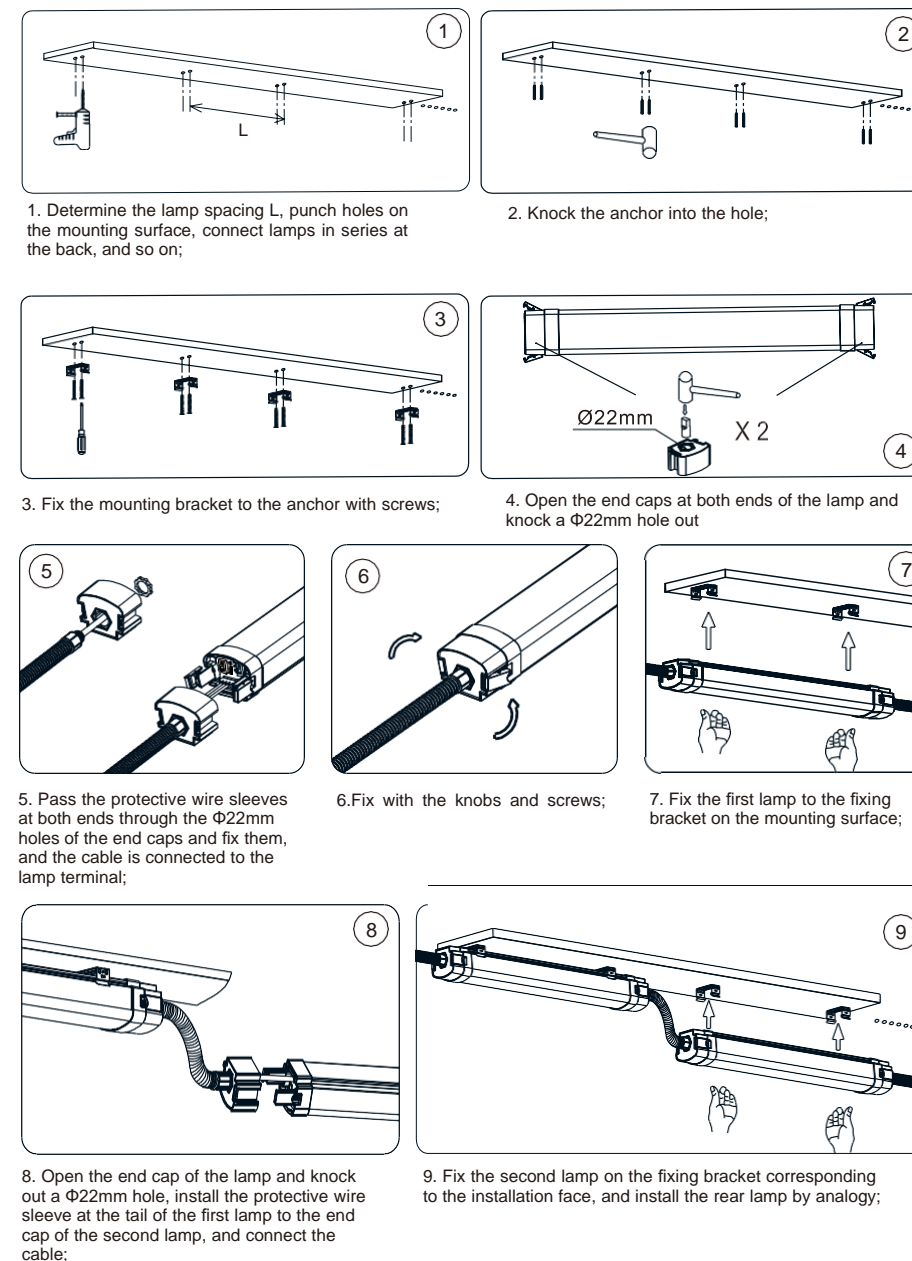

Multi lamps ceiling seamless installation

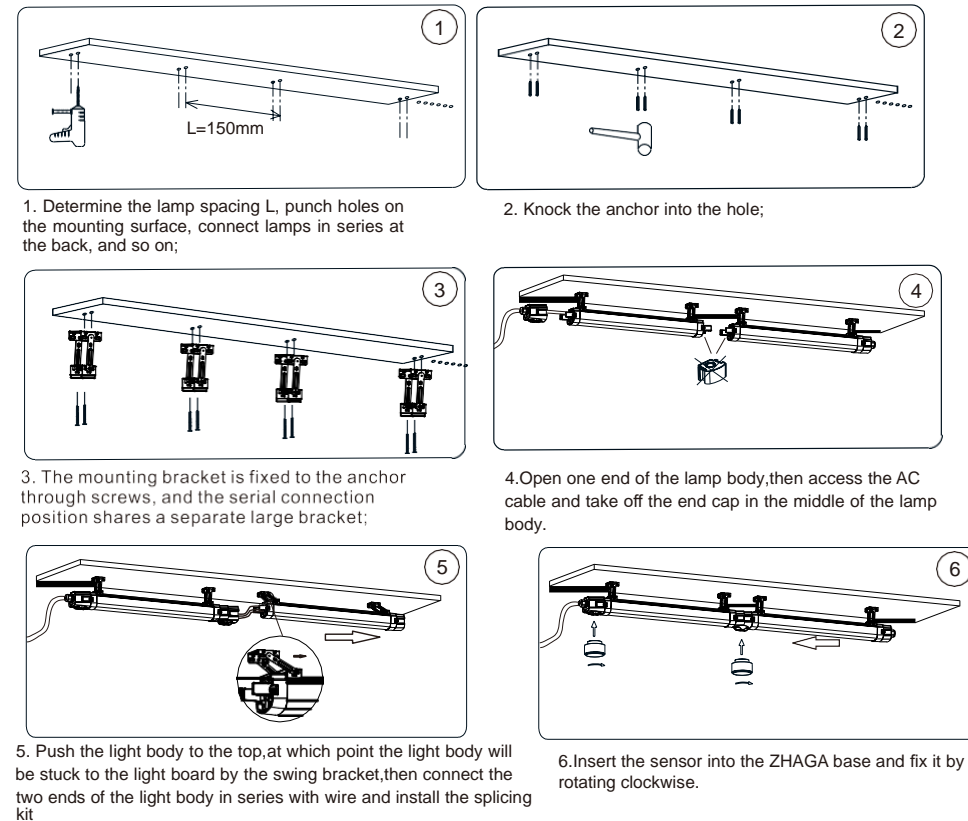

Multi lamps ceiling seamless installation

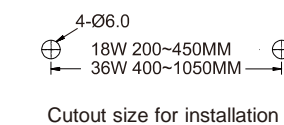

Cutout size for installation

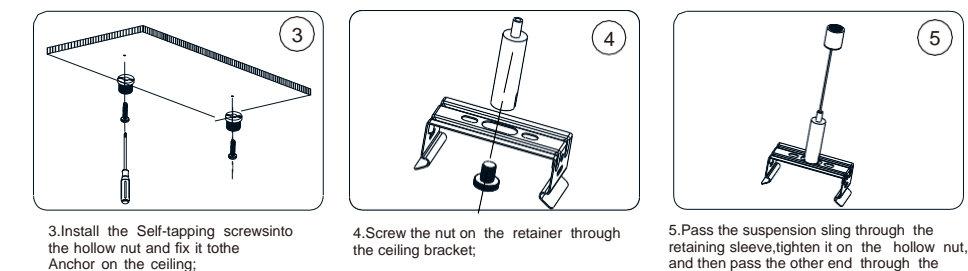

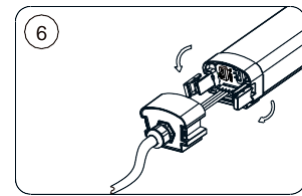

6. Turn the lamp holder counterclockwise, connect the AC cable to the terminal through M20 waterproof connector, and then plug the terminal into the end cap;

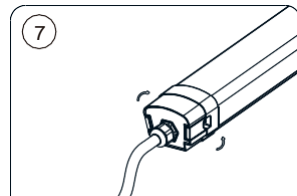

7. Turn the lamp holder clockwise and tighten it;

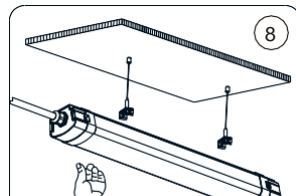

8. Fix the lamp into the clip of suspension rope;

Sling installation of multi lamp wire in series

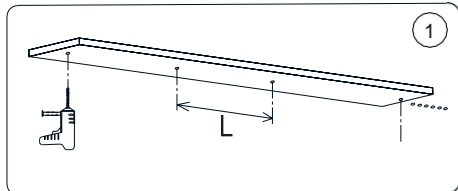

1. Determine the lamp spacing L, punch holes on the mounting surface, connect lamps in series at the back, and so on;

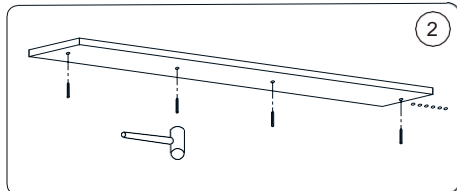

2. Knock the anchor into the hole;

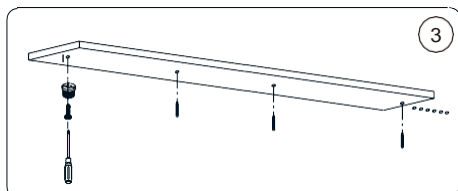

3. Fix the mounting bracket to the anchor with screws;

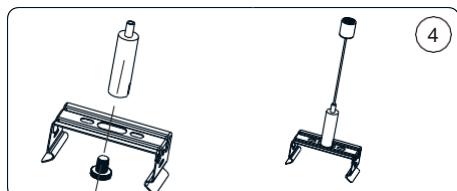

4. Fix the bracket and steel wire rope;

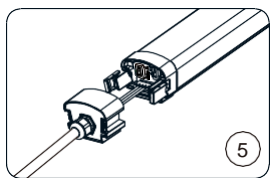

5. Open the lamp end cap and connect the cable to the lamp terminal;

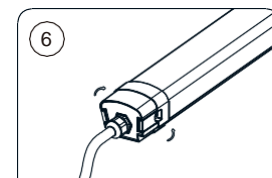

6. Fix with the knobs and screws;

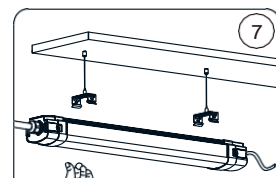

7. Fix the first lamp to the fixed bracket;

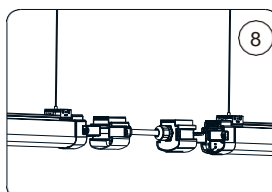

8. Open the end cap of the lamp and knock out Φ22mm hole, install the protective wire sleeve at the tail of the first lamp to the end cap of the second lamp, and connect the cable;

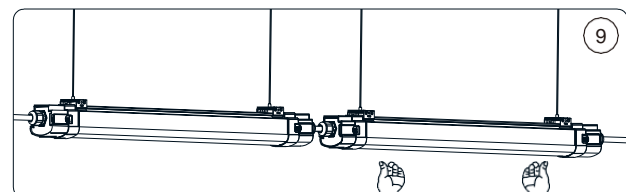

9. Fix the second lamp on the fixing bracket corresponding to the installation face, and install the rear lamp by analogy;

Seamless sling installation of multi lamps

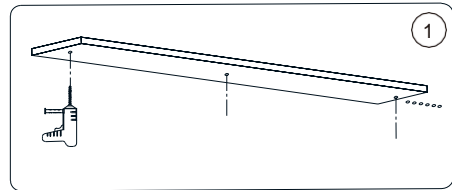

1. Drill a hole on the mounting surface, and the following shall be connected in series, and so on;

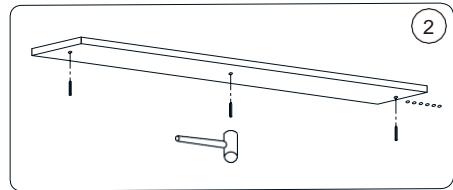

2. Knock the anchor into the hole

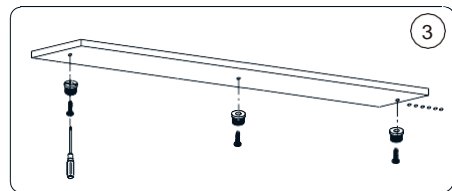

3. Fix the nut to the anchor with screws;

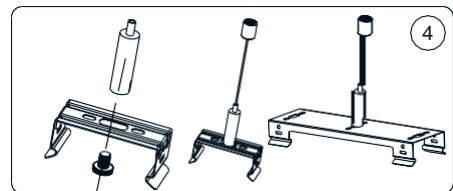

4. Fix the bracket and steel wire rope;

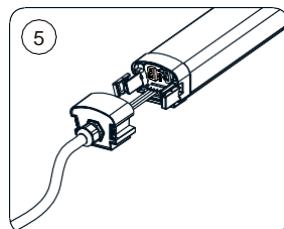

5. Open the lamp end cap and connect the cable to the lamp terminal;

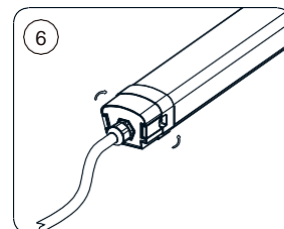

6. Fix with the knobs and screws;

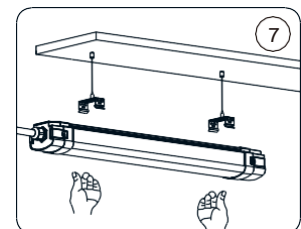

7. Fix the first lamp to the fixed bracket;

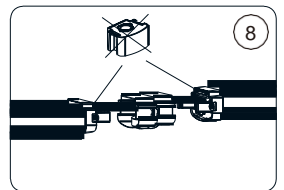

8. Remove the lower end cap, pass the cable through the docking module to connect the first light and the second light together, connect the cable, and fasten the docking module through the button;

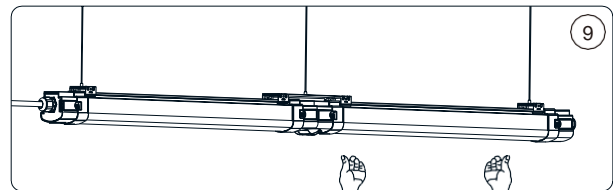

9. Fix the second lamp to the fixed bracket, and install the rear lamp by analogy;

Single ended sensor installation

Before installing the sensor, please confirm that the lamp power supply is compatible with the sensor

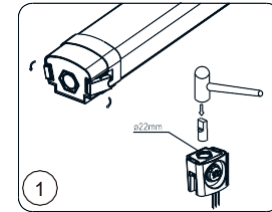

1. Remove the end cap;

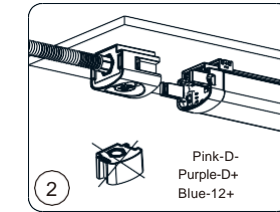

2. Connect the lamp sensor module base with the lamp and fasten it;

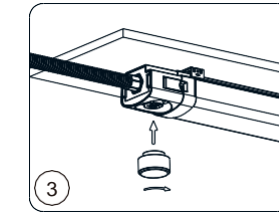

3. Insert the sensor into the ZHAGA base and rotate it clockwise to fix it;

Docking sensor installation

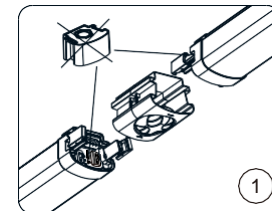

1. Remove the lamp end cap or docking module;

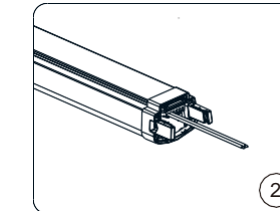

2. Connect the AC line to the end of the front light;

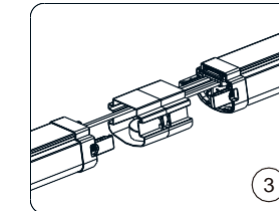

3. The AC wire passes through the splicing module to the AC terminal interface of the next lamp, and the wire on the ZHAGA base is also connected to the terminal interface of the next lamp;

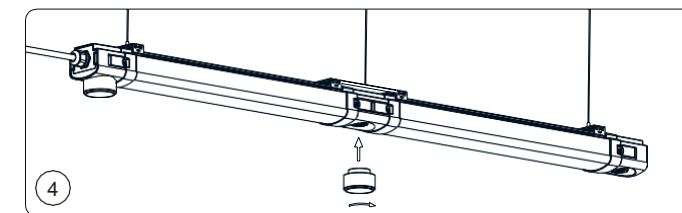

4. Insert the sensor into the ZHAGA base and rotate it clockwise to fix it;

CCT & Power Adjustable:

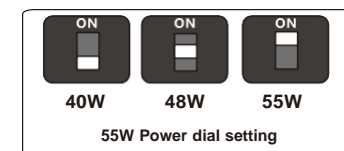

40W 48W 55W

55W Power dial setting

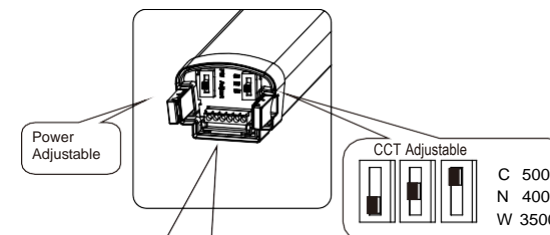

C 5000K
N 4000K
W 3500K

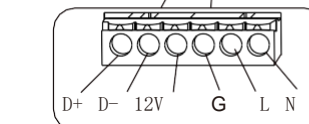

Installation requirement :

1. Please read the instructions carefully before installation.
2. The manufacturer provides wires for seamless installation, and the cables for non-seamless installation are provided by the user.
3. Power off before installation.
4. Thread the input cable through the waterproof joint, and then connect the input wire end with the terminal to ensure reliable contact.
5. Fix the caps at both ends.
6. Choose ceiling installation, fix ceiling bracket on the installation surface via self-tapping screws and flat gasket, then snap the lamp body into bracket.
7. If you choose suspension installation, please first fix the steel wire on the installation surface, and fix the wirelock on bracket with nut, then snap the lamp body into bracket, finally adjust the length of steel wire.

Notice

1. Please first read the product specification carefully, make sure the using environment conform to specification, then it can be used.
2. Please confirm input voltage, frequency before use.
3. The lamp must be installed by professionals.
4. If there is any damage to the power wire or shell of the product, it should be taken as defective product and do not use it.
5. Dangerous high voltage, non-professionals are not allowed to maintain the product.
6. If external soft cable or soft wire of the light is damaged, it should be replaced by manufacturer or service agent or personnel with similar qualification to avoid danger.
7. When connect wire of AC, the terminal shouldn't press to external skin, ensure good contact.
8. Please do not let water enter the internal, please do not knock against the LEDs' surface.
9. Corrosivity in the using environment can't exceed the anti-corrosion grade regulation, if you have special requirement, please first consult with our company.
10. Working environment temperature of products with emergency function: 0°C ~ 40°C.
11. Side Installation on wall surface is not allowed.
12. Outdoor site application is prohibited.
13. Protective wire sleeve that used in installation is the flexible conduit suitable for wet location.